

**MATHS**  
**YEAR 4**  
**MEASUREMENT**

**NC. Objective:** To find the area of rectilinear shapes by counting squares.

1. This is the floorplan of Hamlet's bedroom which shows how much space each piece of furniture takes up. Each square represents  $1\text{m}^2$ . Find the area in  $\text{m}^2$  of each piece of furniture covers then complete the comparisons underneath using  $<$ ,  $>$  or  $=$ .

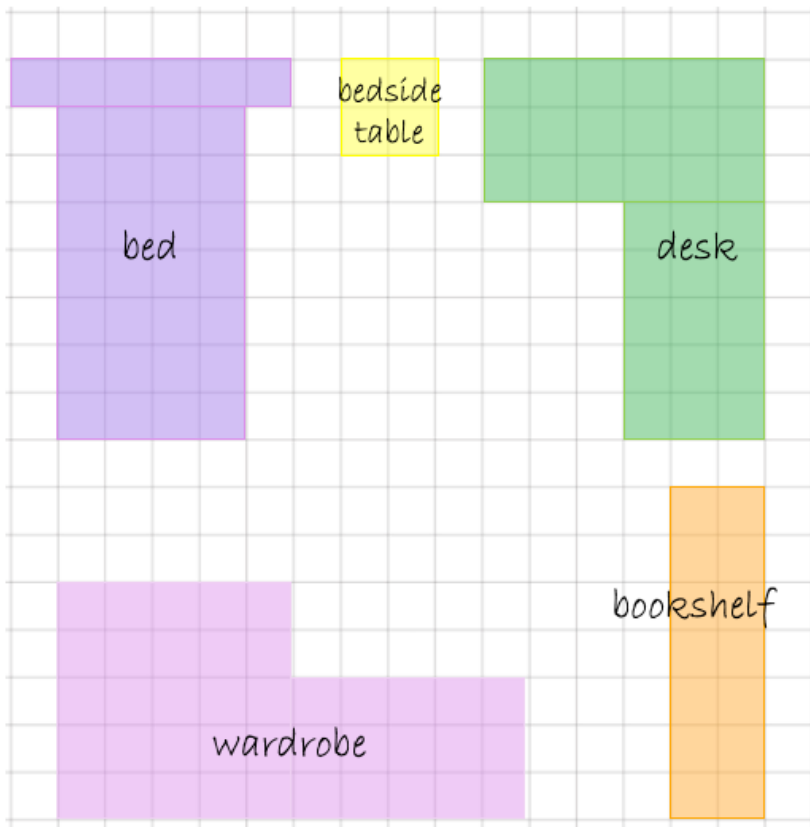

bed: \_\_\_\_\_  
bedside table: \_\_\_\_\_  
desk: \_\_\_\_\_  
bookshelf: \_\_\_\_\_  
wardrobe: \_\_\_\_\_

bedside table  bed

wardrobe  desk

bookshelf  bed

wardrobe  bookshelf

bookshelf  desk

wardrobe  bedside table

2. On the  $1\text{cm}^2$  grid below, draw as many rectilinear shapes as you can that have an area of  $24\text{ cm}^2$ .

